

V - Fuses

Fuses for Battery Powered Forklifts and Industrial Vehicles



Voltage Ratings - 36V_{DC} and 80V_{DC}

Rated Breaking Capacity - $6 \times I_n, 0 = 3ms @ 48V_{DC}$

Current Ratings;

36V_{DC}/80V_{DC} - 25A - 150A

80V_{DC} - 20A - 500A

Standards;

For 80V_{DC} Fuses - DIN 43560 Part 1

For 36V_{DC}/80V Fuses - DIN 72581-2

Specifications:

Load Current Opening Time

80V Fuses

150%	> 1 h
180%	< 1h
250%	0.8s - 10s
400%	0.2s - 2s

24V Fuses

130%	$\geq 1h$
250%	$\leq 1m$



FUSES

V	Rated Voltage [Un] 80V _{DC}	Fuses for Battery Powered Forklifts and Industrial Vehicles	Standard(s) DIN 43560 -part 1
Size - Form A - Open Frame, Frame B - Enclosed Form			

Time-Current Characteristics

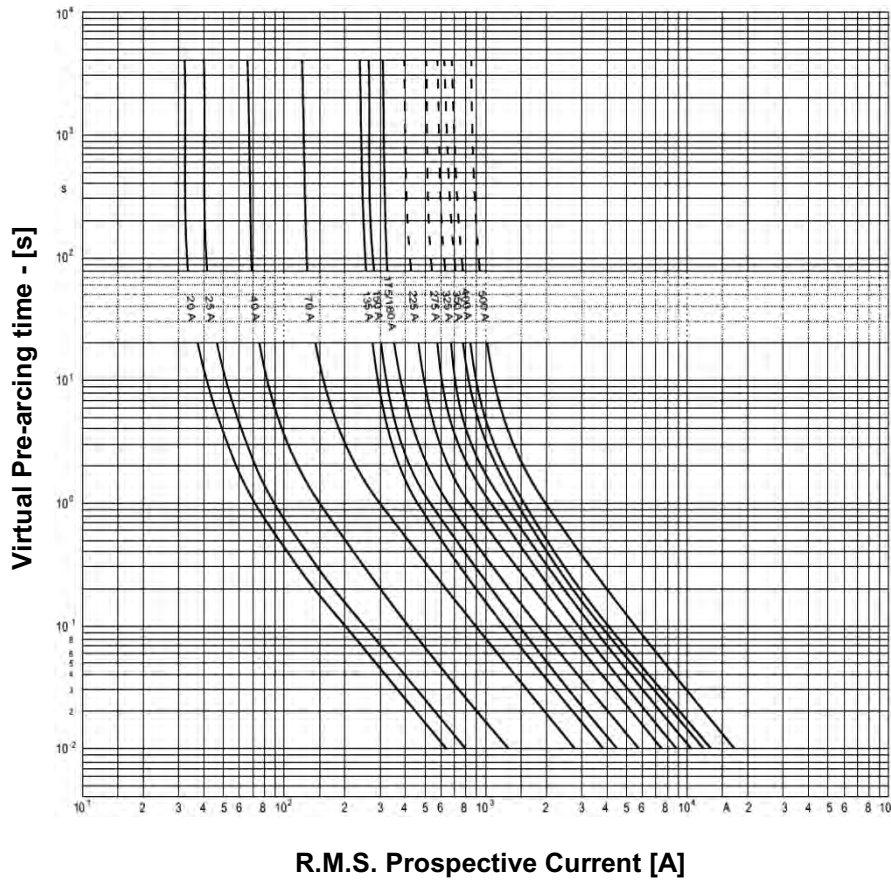



FUSES

V Rated Voltage [Un] 80V_{DC} Fuses for Battery Powered Forklifts and Industrial Vehicles Standard(s) DIN 43560 -part 1

Size - Form A - Open Frame, Frame B - Enclosed Form

Time-Current Characteristics

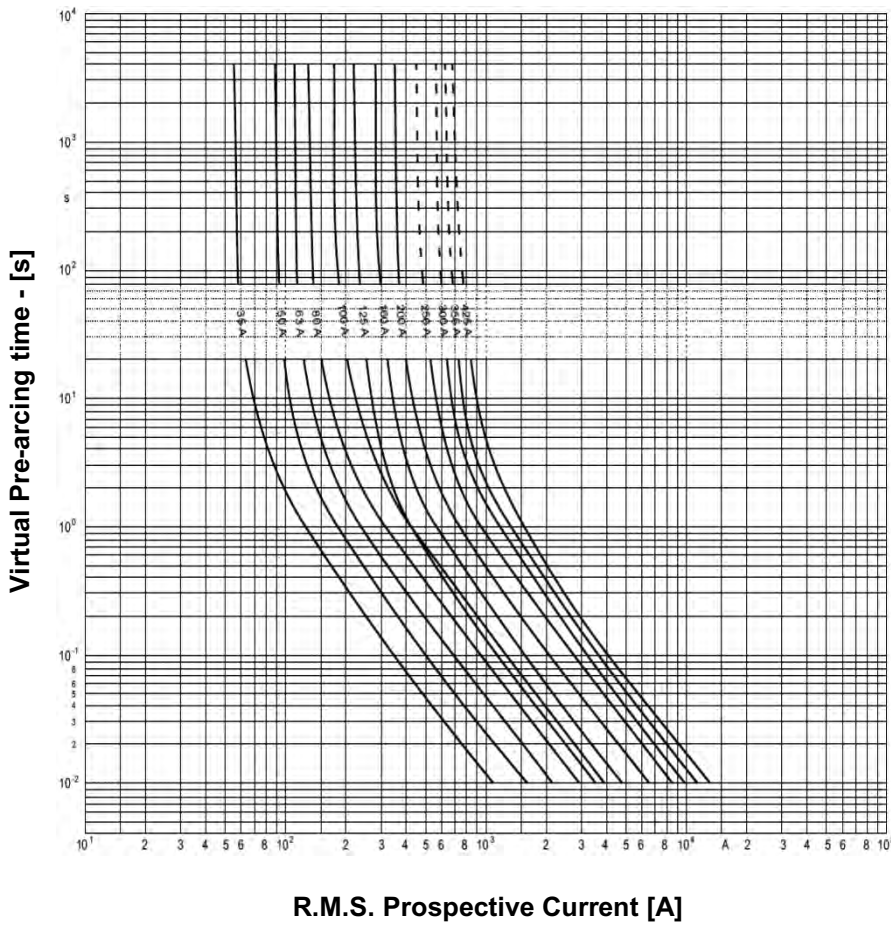

V **Rated Voltage** **Fuses for Battery Powered Forklifts and Industrial Vehicles** **Standard(s)**
 [Un] **DIN 72581-2**
 36V_{DC}
 80V_{DC}

Size - Form A - Open Frame, Frame B - Enclosed Form

Rated Current I _n [A]	Form A 36V _{DC}	Form B 80V _{DC}	Weight [kg / 100]		Power Loss [W]	Cold Resistance [mΩ]
	Article Number	Article Number	90 054 09	90 059 09		
25	9005409.25	9005909.25	0.025	0.39	1.3	3.00
30	9005409.30	9005909.30	0.025	0.39	1.4	1.75
35	9005409.35	9005909.35	0.025	0.39	2.2	1.50
40	9005409.40	9005909.40	0.025	0.39	1.8	0.96
50	9005409.50	9005909.50	0.05	0.39	3.1	0.96
63	9005409.63	9005909.63	0.05	0.39	3.6	0.71
80	9005409.80	9005909.80	0.11	0.39	3.5	0.57
100	9005409.100	9005909.100	0.4	0.39	5.0	0.57
125	9005409.125	9005909.125	0.4	0.49	6.0	0.45
150	9005409.150	9005909.150	0.4	0.49	6.7	0.37
Units per Package						
			100	40		

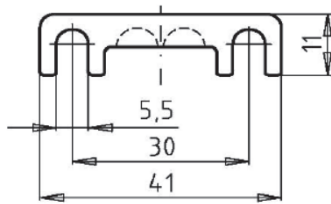

9005409

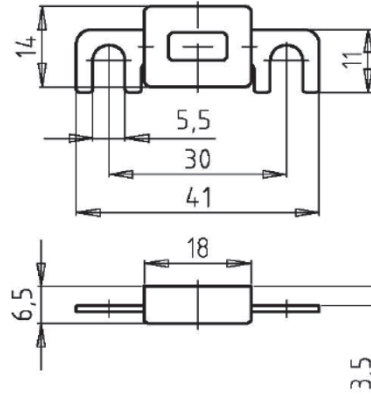

9005909



FUSES

V	Rated Voltage [Un] 36V _{DC} 80V _{DC}	Fuses for Battery Powered Forklifts and Industrial Vehicles	Standard(s) DIN 72581-2
Size - Form A - Open Frame, Frame B - Enclosed Form			

Time-Current Characteristics

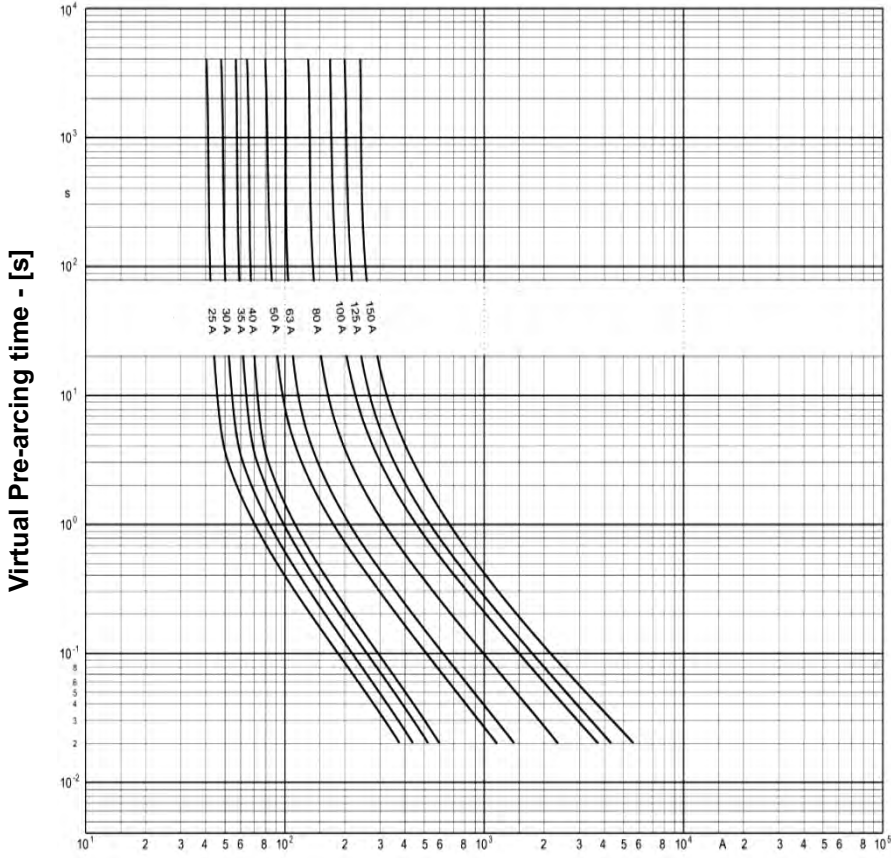

R.M.S. Prospective Current [A]